

HOW TO ATTACH THE COVER TO THE REEL

Step 1. Position the reel on the pool. The reel should be placed as close as is practical to the edge of the pool (to minimise dragging over the edge).

On a rectangular pool place it at one end - if there is a step out, it should be at the opposite end. (The step is folded back onto the cover prior to rolling up onto the reel, so having it at the opposite end means it rolls on more smoothly).

To attach the cover to the reel, simply unscrew the ends of the attachment straps.

Puncture the cover with the screwdriver, insert the screw end of the clip through the cover, replace the clip and tighten. If you have trouble using your fingers, a 20c piece fits perfectly into the slot.

TIP: Don't attach the clip too close to the edge of the cover - give it at least 4-6cm to reduce the risk of it tearing through.

Once your cover is attached, adjust the straps to make sure they are evenly tensioned, to ensure the cover rolls on and off evenly.

When on the pool, the solar cover should be sitting flat on the pool (bubble side facing down, into the water).

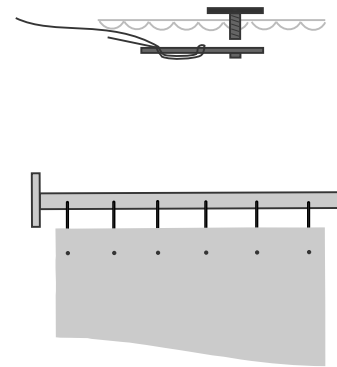

HOW TO ATTACH THE OVER-COVER

Every time your solar cover is rolled up on the reel, it should be covered by the protective over-cover. This prevents overheating, which can occur very quickly.

Rather than using it the traditional way (where the elastic cord stretches over either end of the roller as per the diagrams opposite), you may like to simply cut the overcover to size, and attach it directly to the end of the blanket with some eyelets.

This way the overcover will always cover the blanket when it is rolled up, and it will look a little neater under the bench.

Option 2 (Attach to cover)

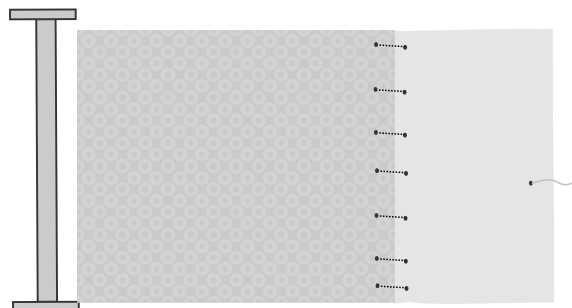

Option 1 (Traditional Method)

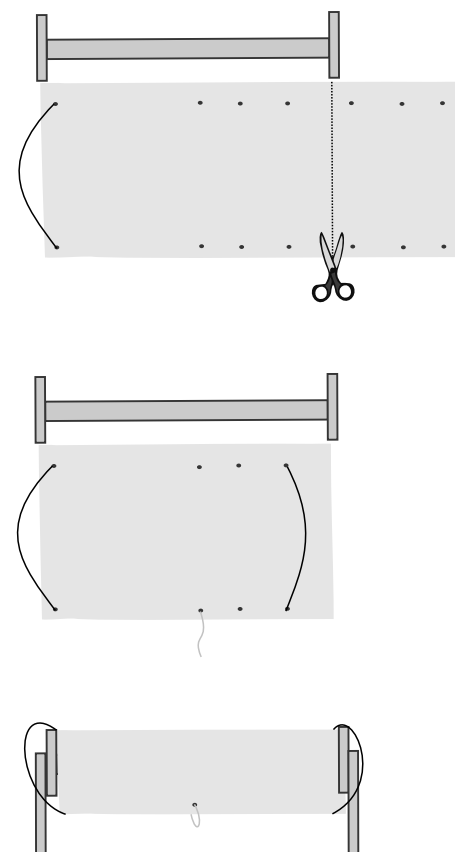

HOW TO ASSEMBLE THE NEPTUNE BENCH REEL

Domestic Reel System
For the storage of solar and thermal pool covers
Model HNBTRC_



Prefer a video instruction?
← Scan here

WHAT'S SUPPLIED:

This reel comes in 2 parts. Please check you have everything before starting.

Bench top planks (3 or 6, depending on bench length)	Aluminium Tubes (1,2 or 3)
3 x Joiner caps (6 plank systems only)	2 x Locking pins
1 x Crank Handle	2x Allen keys (1 with the tube, 1 with the end kit)
2 x End-Frames	2 x Lock collar
1 x Centre Join support (6 plank systems only)	2 x black plastic guides (spare)
3 x Flat bars (6 plank systems only)	1 x Blanket attachment kit
6 or 12 Nut/Bolt sets	1 X Protective overcover

NOT SUPPLIED BUT WILL BE USEFUL: A rubber mallet and an adjustable spanner. When attaching the cover, you will also need a pair of scissors if you want to trim the overcover, and a screwdriver is useful to pierce the cover when attaching straps.

Optional: If you do not plan to disassemble this bench and prefer to use tek screws instead, you will need 2 Aluminium Tek screws and a power drill.

Supplied by ABGAL Liners & Covers
56 Magnesium Drive Crestmead Qld 4132

For consumer support, please go to www.abgal.com.au
or email us@abgal.com.au



JOIN THE TUBES

The number of tubes you have depends on the width of the reel. If you have a tube which has been pre-inserted into a larger tube it will have been secured for transit with a small screw. *This screw needs to be removed before inserting another tube.*

The two 'outside' tubes have the end axle pieces pre-fitted. The inside 'joining' ends have 3 black plastic guides pre-fitted. Check these are evenly spaced - if you break one there are spares, but don't panic - they're not critical.

Lay the tubes out ready for joining with an axle either end. Identify the keyway channel, and insert one locking pin (screw end first). Insert from the 'joining end' and slide down out of the way, toward the axle.

Repeat with the joining end of the other tube.

Now slide the tubes together - you may need to twist them around a little so the internal grooves fit into one another. (When the internal grooves fit, the external keyway channels will not be aligned - don't try and make them).

For maximum strength, the inside overlap on the tubes should be as equal as possible, with a minimum of 45cm overlap in each tube for stability.

Once you have the tube at the correct length, slide the locking pins back towards (and into) the overlap. When they are in the correct position, you should only see the head of the screw. **TIP:** Holding one tube at a slight angle will let you get the locking pins in as close as possible.

Don't tighten with the allen key yet as you will need to adjust the tube length when you insert it into the bench.

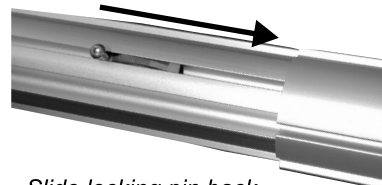
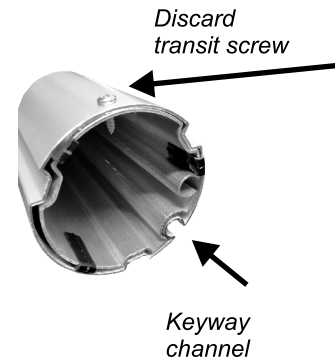

Slide locking pin back towards the join. Push it into the next tube so only the screw is visible.



JOIN THE BENCH PLANKS

1. If you have planks to join, insert a plastic joiner cap into the end of one, then slide the next plank onto the other end. You may need to give them a tap with a rubber mallet to ensure they are in firmly.

Repeat with remaining planks/joiners, then remove the protective plastic wrap and lay them face down on a towel or large piece of cardboard to prevent scratching. (Powdercoated planks can be easily scratched - never place them directly onto a hard surface).

2. Take the guide bars and the bolt sets, and put the bolts through the bars - the bar has a slight curve - the arch faces upwards.

3. With the bolts in place, insert the bars in through the end, with the bolts facing up. Push them to the centre of each plank, so a bolt sits either side of the join.



ATTACH THE CENTRE SUPPORT

4. With the planks lined up, place the centre support onto the planks, aligning the holes with the protruding bolts so the bolts pass through. Add the washer then the nut and tighten.

It may be helpful to push the bolt slightly from underneath to make them stand higher. (The allen key is just the right size to sit underneath and push them up).

Once they're all in and hand tightened, add 3 more bolts at one end, ready to attach the first leg.

A second person is helpful at this point, but not critical. you can put the support frame into position, and tighten the nuts using the large allen key.

You may find it easier if you hold them with the spanner.

INSERT THE TUBE INTO THE FRAME

Before putting the tube into the frame, insert the attachment straps into the keyway channel - space approx 60cm apart. They can be inserted from either end.



Now insert the tube into the frame - the axle ends will fit straight into the hole at either end. Once in position, extend the tube out to the full length of the bench, so the axles protrude at either side.

Use the allen key to tighten the locking pins.

If you are not using the locking pins but tek screws instead, now is the time to screw the tube together. Once the tube length is fixed, you can screw the locking collar at the end of one axle, and the crank handle at the other.

